

# HIGHLAND 03

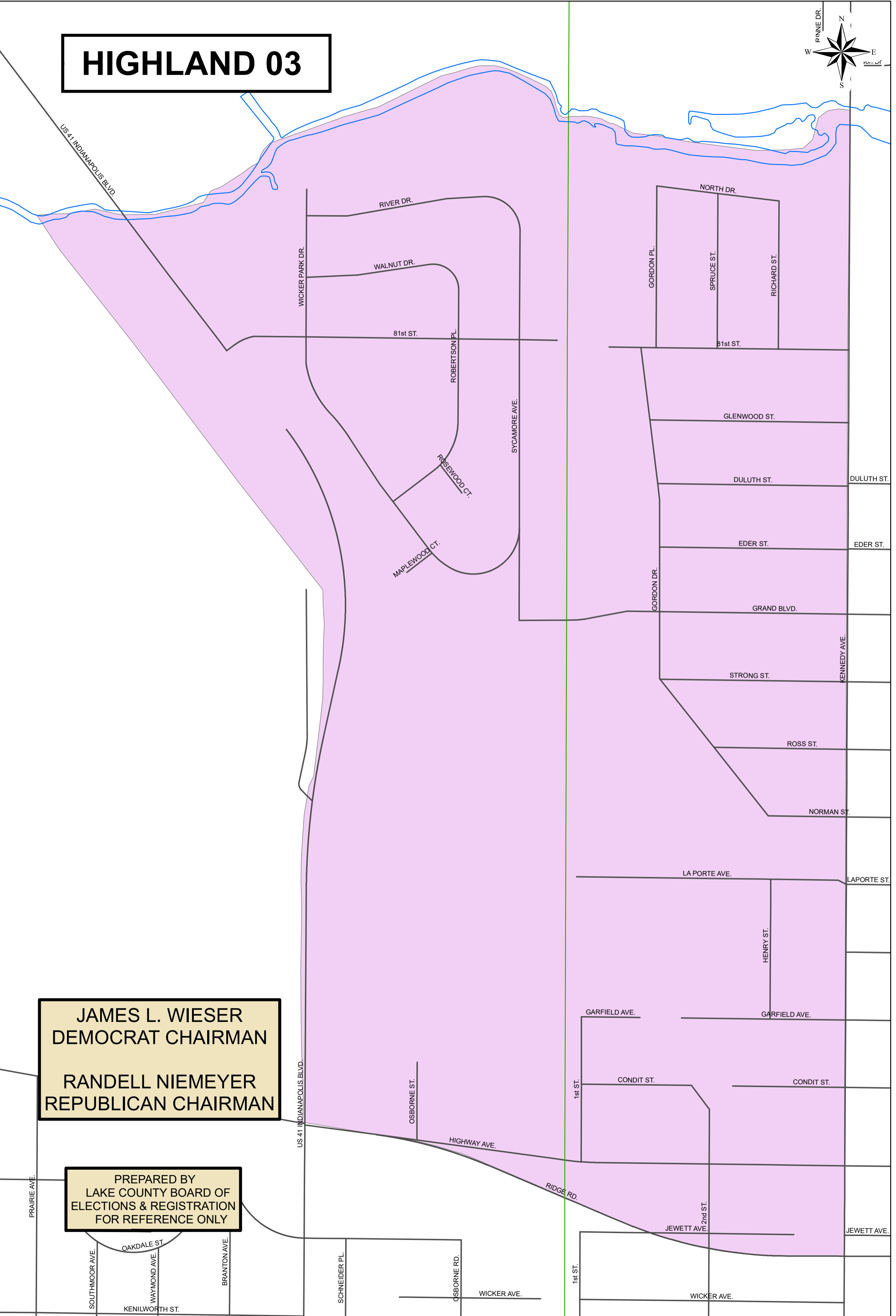
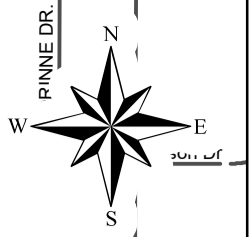

**JAMES L. WIESER**  
DEMOCRAT CHAIRMAN

**RANDELL NIEMEYER**  
REPUBLICAN CHAIRMAN

PREPARED BY  
LAKE COUNTY BOARD OF  
ELECTIONS & REGISTRATION  
FOR REFERENCE ONLY

PRAIRIE AVE.

SOUTHMOOR AVE.

OAKDALE ST.

WAYMOND AVE.

KENILWORTH ST.

BRANTON AVE.

SCHNEIDER PL.

OSBORNE RD.

WICKER AVE.

1st ST.

GARFIELD AVE.

CONDIT ST.

RIDGE RD.

JEWETT AVE.

WICKER AVE.

US 41 INDIANAPOLIS BLVD.

OSBORNE ST.

HIGHWAY AVE.

MAPLEWOOD CT.

ROSEWOOD CT.

81st ST.

WALNUT DR.

RIVER DR.

WICKER PARK DR.

ROBERTSON PL.

SYCAMORE AVE.

GORDON PL.

SPRUCE ST.

RICHARD ST.

NORTH DR.

81st ST.

GLENWOOD ST.

DULUTH ST.

EDER ST.

GRAND BLVD.

STRONG ST.

ROSS ST.

NORMAN ST.

LA PORTE AVE.

HENRY ST.

GARFIELD AVE.

GARFIELD AVE.

1st ST.

CONDIT ST.

2nd ST.

JEWETT AVE.

DULUTH ST.

EDER ST.

KENNEDY AVE.

LAPORTE ST.

JEWETT AVE.

W PINNIE DR.